

Soils Map

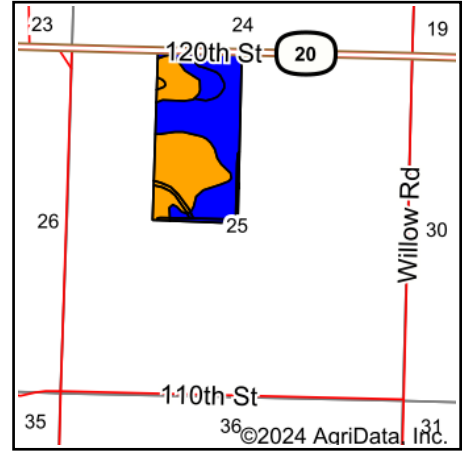

State: **Kansas**
 County: **Brown**
 Location: **25-4S-18E**
 Township: **Washington**
 Acres: **78.63**
 Date: **2/2/2024**

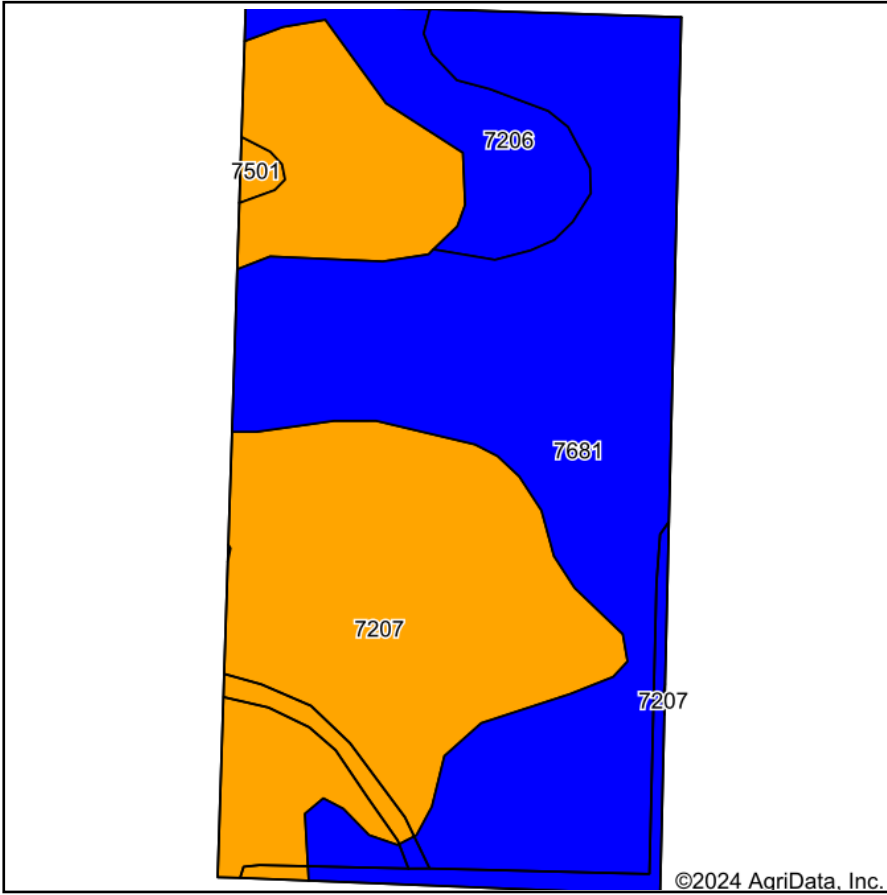

Maps Provided By:

 © AgriData, Inc. 2023 www.AgriDataInc.com



Soils data provided by USDA and NRCS.

Area Symbol: KS013, Soil Area Version: 27

Code	Soil Description	Acres	Percent of field	Non-Irr Class Legend	Non-Irr Class *c	Irr Class *c	Range Production (lbs/acre/yr)	Alfalfa hay Tons	Caucasian bluestem Tons	Common bermudagrass Tons	Orchardgrass red clover Tons	Tall fescue Tons	Warm season grasses Tons	*n NCCPI Soybeans
7681	Wymore silty clay loam, 1 to 3 percent slopes	38.62	49.1%		Ile	Ile	3800							58
7207	Aksarben silty clay loam, 6 to 11 percent slopes	33.45	42.5%		IIle	IVe	4241	4	7	6	7	6	7	61
7206	Aksarben silty clay loam, 2 to 6 percent slopes	6.15	7.8%		Ile	IIIe	4205	4	7	6	7	6	7	60
7501	Pawnee clay loam, 4 to 8 percent slopes, eroded	0.41	0.5%		IIle		3883							39
Weighted Average					2.43	*-	4019.7	2	3.5	3	3.5	3	3.5	*n 59.3

*n: The aggregation method is "Weighted Average using all components"

*c: Using Capabilities Class Dominant Condition Aggregation Method

c: Using Capabilities Class Dominant Condition Aggregation Method- Irr Class weighted average cannot be calculated on the current soils data due to missing data.

Soils data provided by USDA and NRCS.