

Soils Map

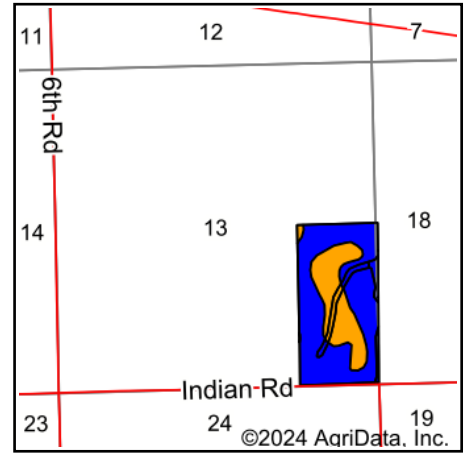

State: **Kansas**
 County: **Marshall**
 Location: **13-2S-6E**
 Township: **Logan**
 Acres: **78.94**
 Date: **1/17/2024**

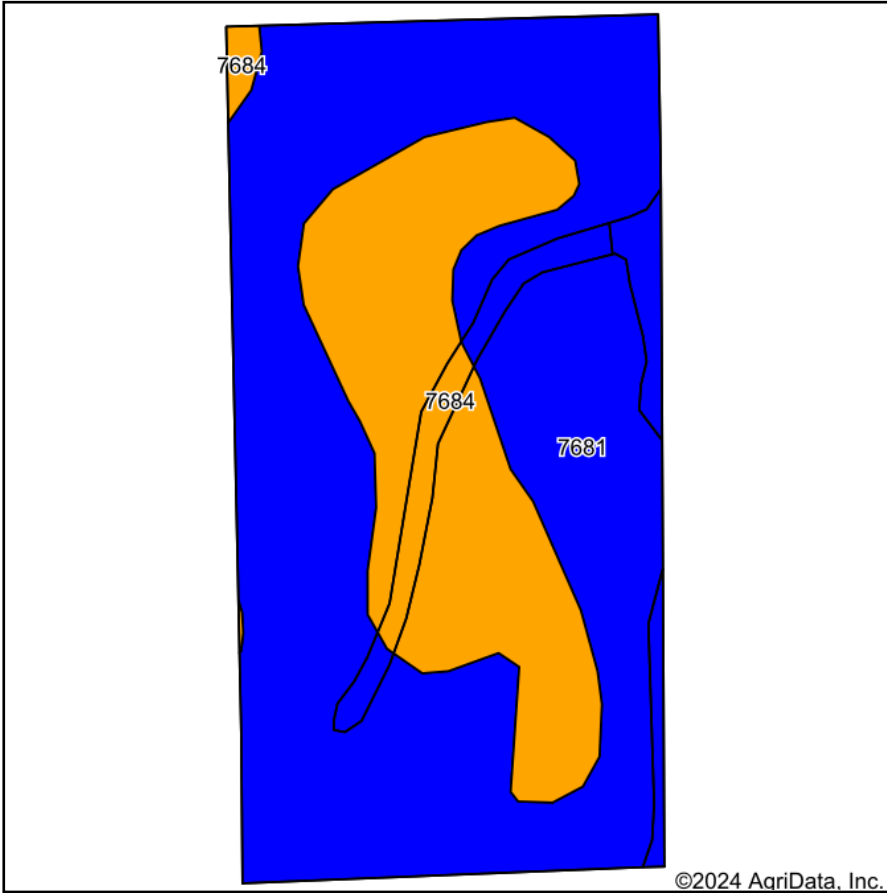

Maps Provided By:



Soils data provided by USDA and NRCS.

©2024 AgriData, Inc.

Area Symbol: KS117, Soil Area Version: 24

Code	Soil Description	Acres	Percent of field	Non-Irr Class Legend	Non-Irr Class *c	Irr Class *c	Range Production (lbs/acre/yr)	*n NCCPI Soybeans
7681	Wymore silty clay loam, 1 to 3 percent slopes	56.24	71.2%		Ile	Ile	3800	58
7684	Wymore silty clay loam, 3 to 6 percent slopes, eroded	22.70	28.8%		IIle	IVe	3832	50
Weighted Average					2.29	2.58	3809.2	*n 55.7

*n: The aggregation method is "Weighted Average using all components"

*c: Using Capabilities Class Dominant Condition Aggregation Method