

Soils Map

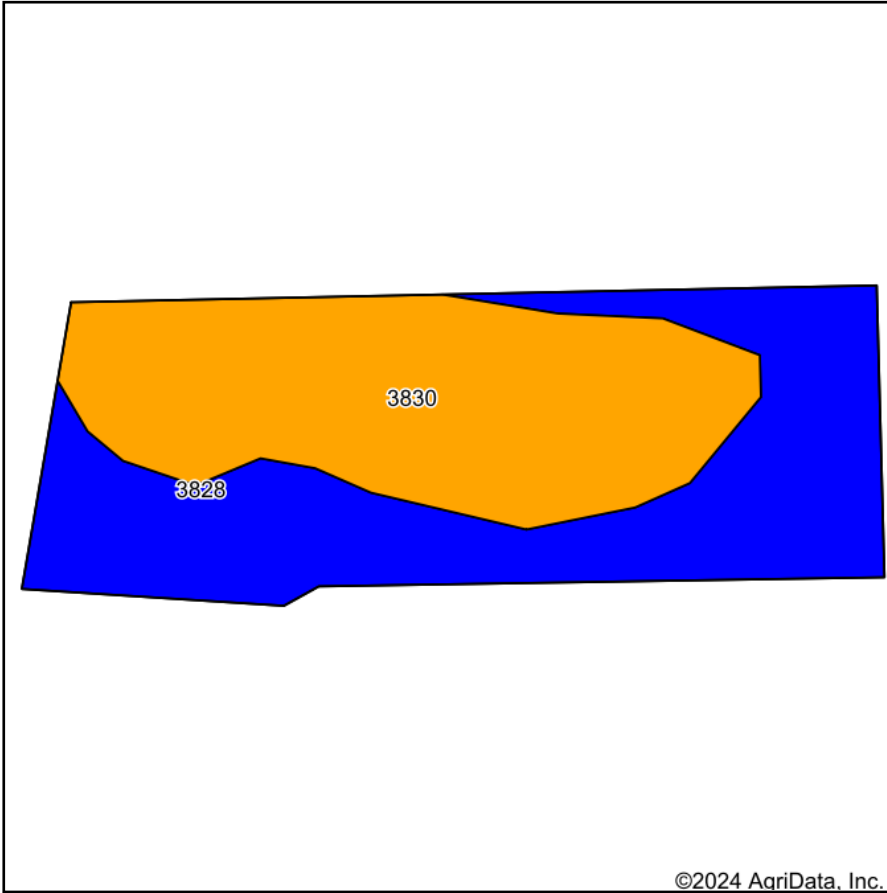

Soils data provided by USDA and NRCS.

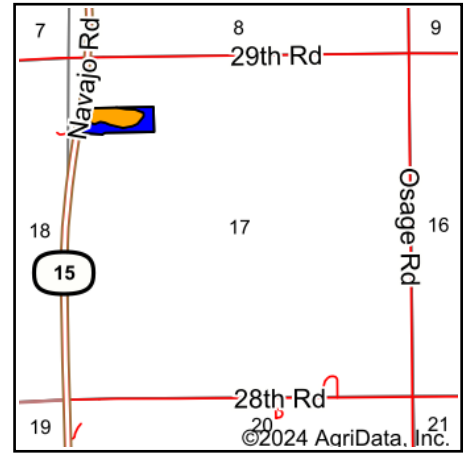

State: **Kansas**
 County: **Clay**
 Location: **17-6S-3E**
 Township: **Garfield**
 Acres: **10.02**
 Date: **4/24/2024**



Maps Provided By:



Area Symbol: KS027, Soil Area Version: 22

Code	Soil Description	Acres	Percent of field	Non-Irr Class Legend	Non-Irr Class *c	Irr Class *c	Range Production (lbs/acre/yr)	*n NCCPI Soybeans
3830	Crete silty clay loam, 3 to 7 percent slopes	5.02	50.1%		IIle	IIle	3655	62
3828	Crete silty clay loam, 1 to 3 percent slopes	5.00	49.9%		Ile	Ile	3645	63
Weighted Average					2.50	2.50	3650	*n 62.5

*n: The aggregation method is "Weighted Average using all components"

*c: Using Capabilities Class Dominant Condition Aggregation Method