

# Soils Map

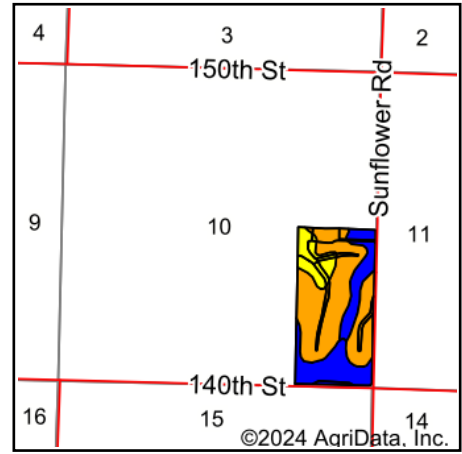

State: **Kansas**  
 County: **Brown**  
 Location: **10-4S-18E**  
 Township: **Washington**  
 Acres: **77.42**  
 Date: **7/20/2024**

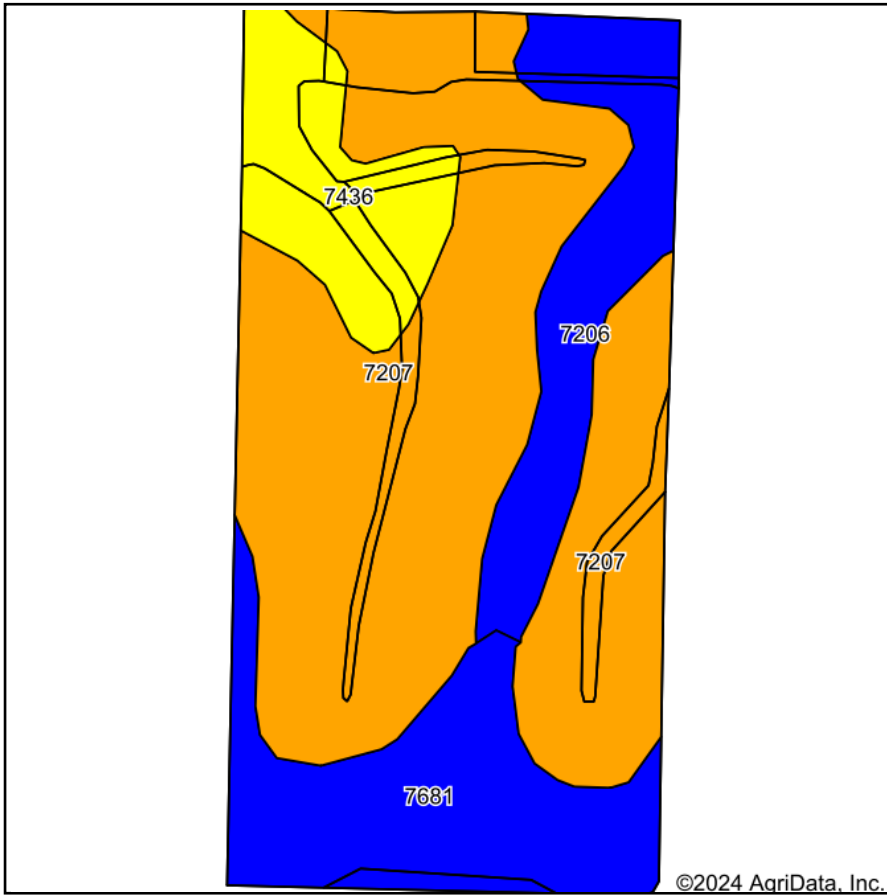

Soils data provided by USDA and NRCS.

Area Symbol: KS013, Soil Area Version: 27

Code	Soil Description	Acres	Percent of field	Non-Irr Class Legend	Non-Irr Class *c	Irr Class *c	Range Production (lbs/acre/yr)	Alfalfa hay Tons	Caucasian bluestem Tons	Common bermudagrass Tons	Orchardgrass red clover Tons	Tall fescue Tons	Warm season grasses Tons	*n NCCPI Soybeans
7207	Aksarben silty clay loam, 6 to 11 percent slopes	44.13	57.0%		IIIe	IVe	4241	4	7	6	7	6	7	61
7681	Wymore silty clay loam, 1 to 3 percent slopes	14.46	18.7%		Ile	Ile	3800							58
7206	Aksarben silty clay loam, 2 to 6 percent slopes	10.20	13.2%		Ile	IIIe	4205	4	7	6	7	6	7	60
7436	Morrill loam, 7 to 12 percent slopes, eroded	8.63	11.1%		IVe		4265							57
<b>Weighted Average</b>					<b>2.79</b>	<b>*-</b>	<b>4156.6</b>	<b>2.8</b>	<b>4.9</b>	<b>4.2</b>	<b>4.9</b>	<b>4.2</b>	<b>4.9</b>	<b>*n 59.9</b>

\*n: The aggregation method is "Weighted Average using all components"

\*c: Using Capabilities Class Dominant Condition Aggregation Method

\*-: Irr Class weighted average cannot be calculated on the current soils data due to missing data.

Soils data provided by USDA and NRCS.