

Soils Map

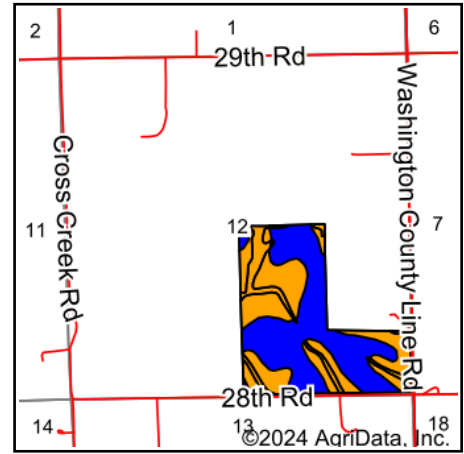

State: **Kansas**
 County: **Washington**
 Location: **12-1S-5E**
 Township: **Independence**
 Acres: **108.02**
 Date: **6/28/2024**

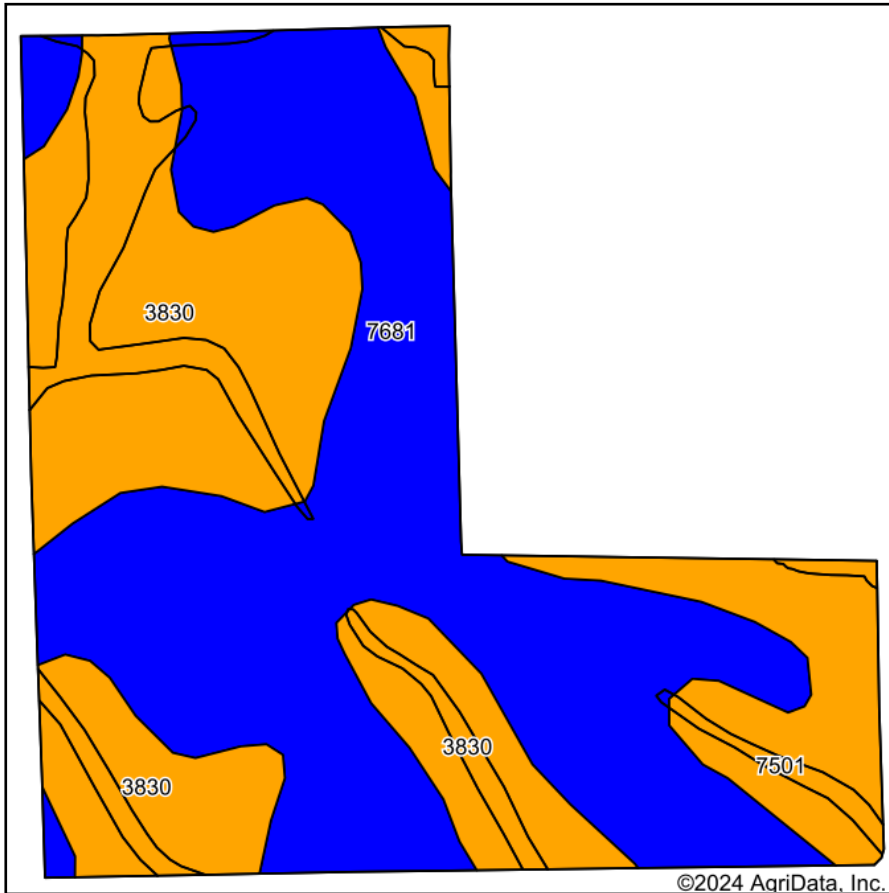

Maps Provided By:



Area Symbol: KS201, Soil Area Version: 23

Code	Soil Description	Acres	Percent of field	Non-Irr Class Legend	Non-Irr Class *c	Irr Class *c	Range Production (lbs/acre/yr)	*n NCCPI Soybeans
7681	Wymore silty clay loam, 1 to 3 percent slopes	56.56	52.4%		Ile	Ile	3800	58
3830	Crete silty clay loam, 3 to 7 percent slopes	39.87	36.9%		IIle	IIle	3655	62
7501	Pawnee clay loam, 4 to 8 percent slopes, eroded	11.59	10.7%		IIle		3883	39
Weighted Average					2.48	*-	3755.4	*n 57.4

*n: The aggregation method is "Weighted Average using all components"

*c: Using Capabilities Class Dominant Condition Aggregation Method

*- Irr Class weighted average cannot be calculated on the current soils data due to missing data.