

Soils Map

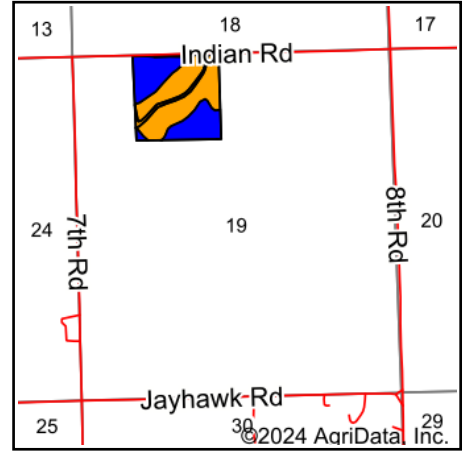

Soils data provided by USDA and NRCS.



State: **Kansas**
 County: **Marshall**
 Location: **19-2S-7E**
 Township: **Marysville**
 Acres: **39.11**
 Date: **6/20/2024**



Maps Provided By:



Area Symbol: KS117, Soil Area Version: 24

Code	Soil Description	Acres	Percent of field	Non-Irr Class Legend	Non-Irr Class *c	Irr Class *c	Range Production (lbs/acre/yr)	*n NCCPI Soybeans
7684	Wymore silty clay loam, 3 to 6 percent slopes, eroded	22.51	57.6%		IIIe	IVe	3832	50
7681	Wymore silty clay loam, 1 to 3 percent slopes	16.60	42.4%		Ile	Ile	3800	58
Weighted Average					2.58	3.15	3818.4	*n 53.4

*n: The aggregation method is "Weighted Average using all components"

*c: Using Capabilities Class Dominant Condition Aggregation Method