

Soils Map

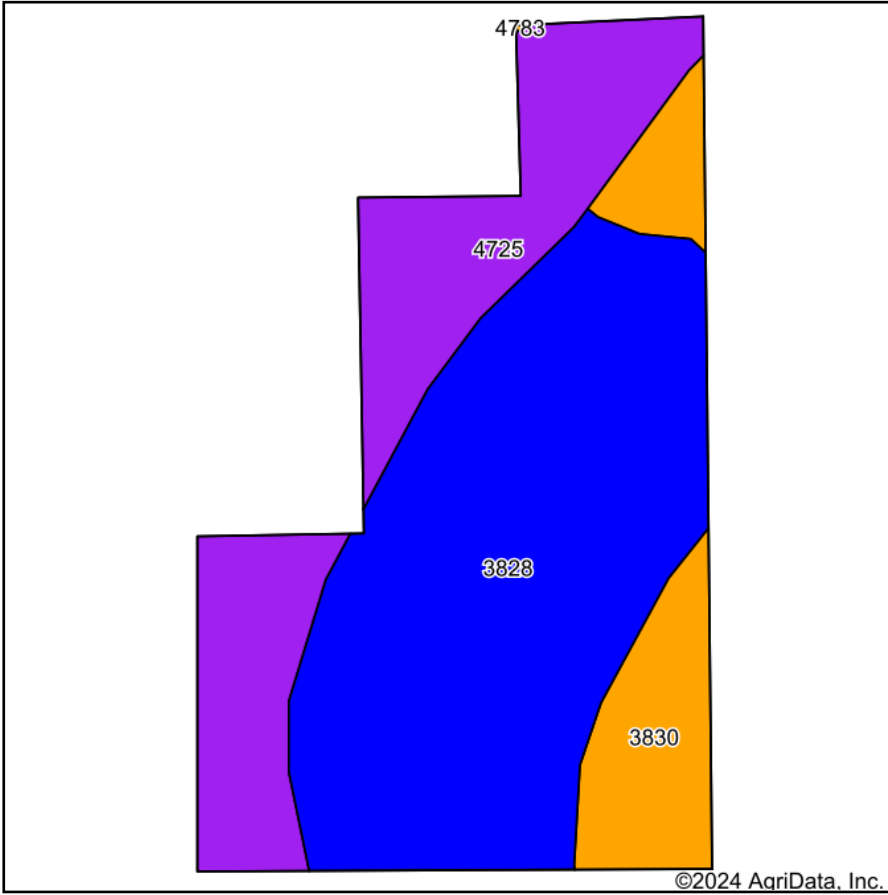

Soils data provided by USDA and NRCS.

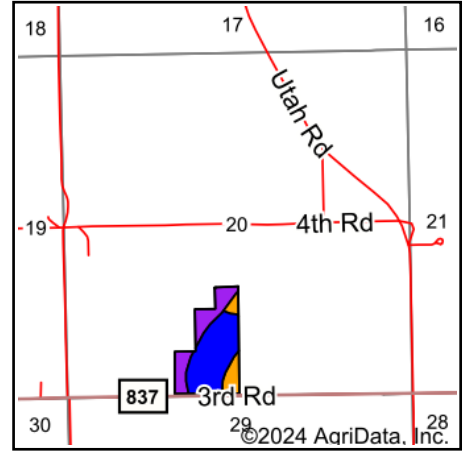

State: **Kansas**
 County: **Clay**
 Location: **20-10S-4E**
 Township: **Republican**
 Acres: **27.98**
 Date: **9/25/2024**



Maps Provided By:



Area Symbol: KS027, Soil Area Version: 22

Code	Soil Description	Acres	Percent of field	Non-Irr Class Legend	Non-Irr Class *c	Irr Class *c	Range Production (lbs/acre/yr)	*n NCCPI Soybeans
3828	Crete silty clay loam, 1 to 3 percent slopes	16.01	57.2%		Ile	Ile	3645	63
4725	Kipson-Sogn complex, 5 to 30 percent slopes	8.16	29.2%		Vls		2710	25
3830	Crete silty clay loam, 3 to 7 percent slopes	3.81	13.6%		IIle	IIle	3655	62
Weighted Average					3.30	*-	3373.7	*n 51.8

*n: The aggregation method is "Weighted Average using all components"

*c: Using Capabilities Class Dominant Condition Aggregation Method

*- Irr Class weighted average cannot be calculated on the current soils data due to missing data.