

Soils Map

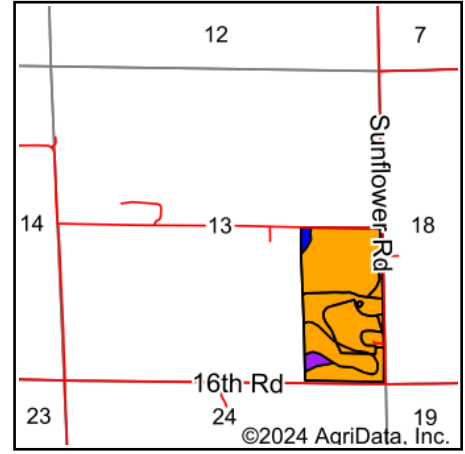

State: **Kansas**
 County: **Clay**
 Location: **18-8S-4E**
 Township: **Clay Center**
 Acres: **80.06**
 Date: **8/18/2024**

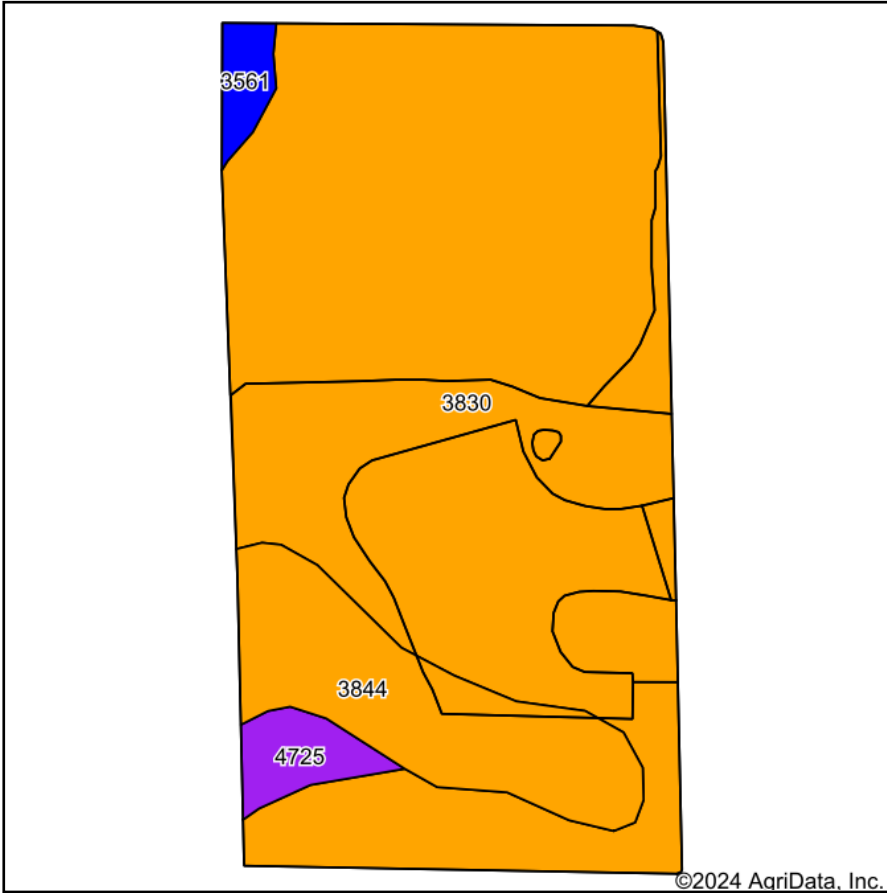

Maps Provided By:



© AgriData, Inc. 2023

www.AgriDataInc.com



Soils data provided by USDA and NRCS.

Area Symbol: KS027, Soil Area Version: 22

Code	Soil Description	Acres	Percent of field	Non-Irr Class Legend	Non-Irr Class *c	Irr Class *c	Range Production (lbs/acre/yr)	*n NCCPI Soybeans
3830	Crete silty clay loam, 3 to 7 percent slopes	66.09	82.5%		Ille	Ille	3655	62
3844	Geary silt loam, 3 to 7 percent slopes	10.63	13.3%		Ille	Ille	4085	71
4725	Kipson-Sogn complex, 5 to 30 percent slopes	2.08	2.6%		Vls		2710	25
3561	Hobbs silt loam, occasionally flooded	1.26	1.6%		Ilw	Ilw	5845	79
Weighted Average					3.06	*-	3722	*n 62.5

*n: The aggregation method is "Weighted Average using all components"

*c: Using Capabilities Class Dominant Condition Aggregation Method

*- Irr Class weighted average cannot be calculated on the current soils data due to missing data.