

Soils Map

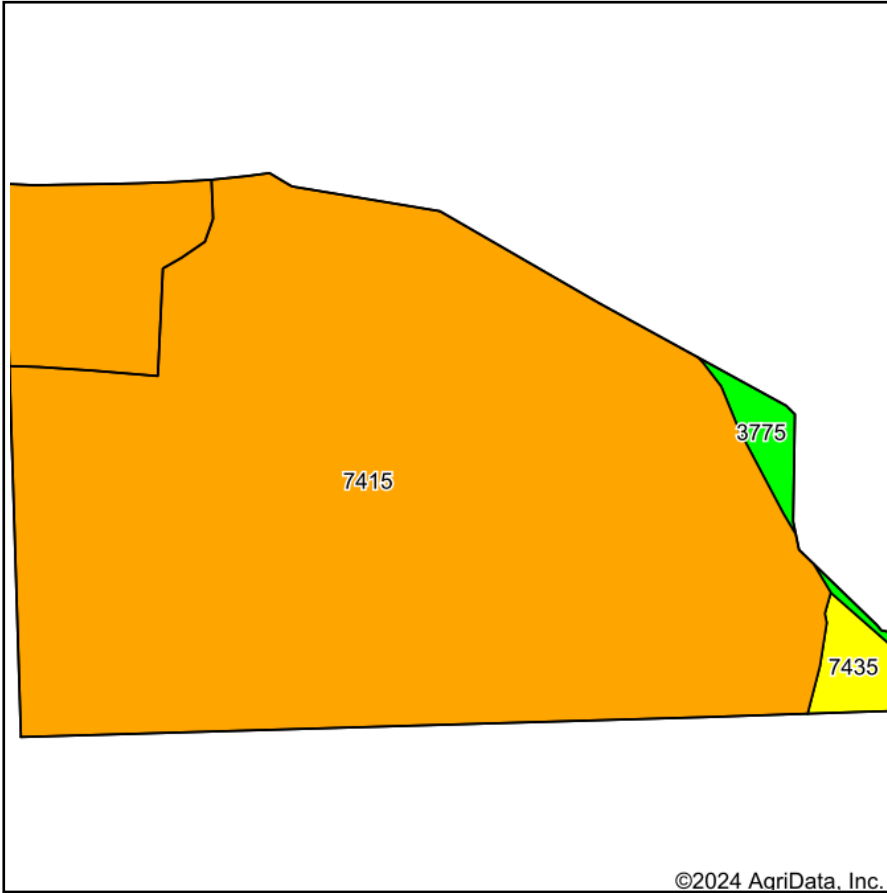

Soils data provided by USDA and NRCS.

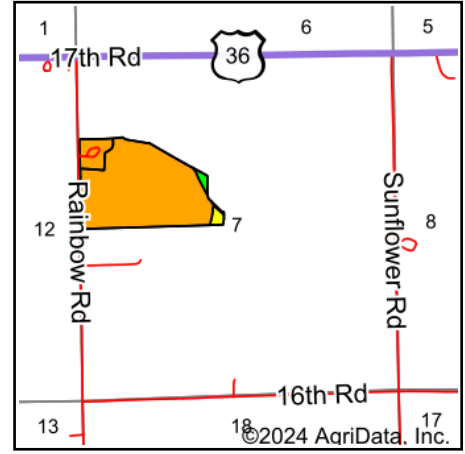

State: **Kansas**
 County: **Washington**
 Location: **7-3S-4E**
 Township: **Logan**
 Acres: **55.72**
 Date: **8/22/2024**



Maps Provided By:



© AgriData, Inc. 2023

www.AgriDataInc.com



Area Symbol: KS201, Soil Area Version: 23									
Code	Soil Description	Acres	Percent of field	Non-Irr Class Legend	Non-Irr Class *c	Irr Class *c	Range Production (lbs/acre/yr)	*n NCCPI Soybeans	
7415	Mayberry clay loam, 3 to 7 percent slopes	53.80	96.6%			IIIe	3970	49	
7435	Morrill loam, 7 to 12 percent slopes	1.02	1.8%			IVe	4219	63	
3775	Muir silt loam, rarely flooded	0.90	1.6%			Iw	4045	82	
Weighted Average						2.99	*-	3975.8	*n 49.8

*n: The aggregation method is "Weighted Average using all components"

*c: Using Capabilities Class Dominant Condition Aggregation Method

*-: Irr Class weighted average cannot be calculated on the current soils data due to missing data.