

Soils Map

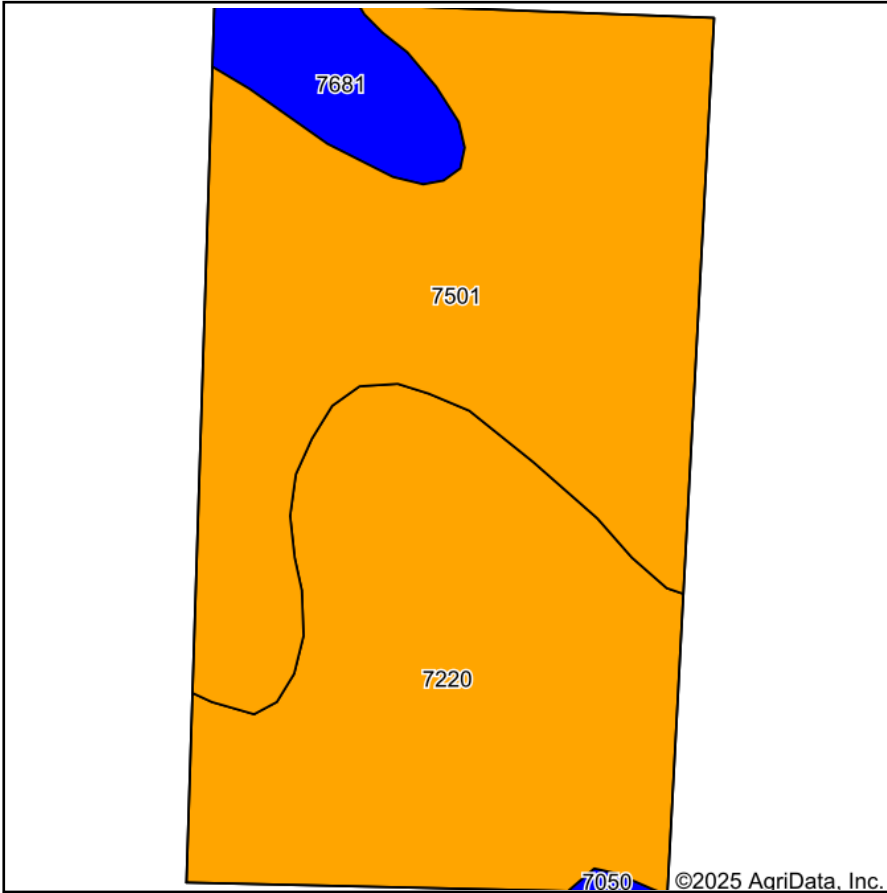

Soils data provided by USDA and NRCS.

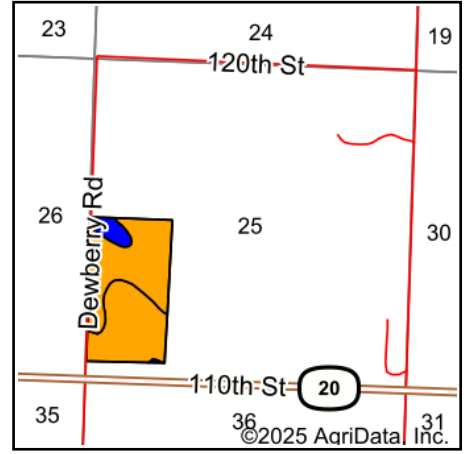

State: **Kansas**
 County: **Brown**
 Location: **25-4S-15E**
 Township: **Powhattan**
 Acres: **71.26**
 Date: **2/5/2025**



Maps Provided By:



Area Symbol: KS013, Soil Area Version: 28

Code	Soil Description	Acres	Percent of field	Non-Irr Class Legend	Non-Irr Class *c	Irr Class *c	Range Production (lbs/acre/yr)	Corn Bu	Soybeans Bu	*n NCCPI Soybeans
7501	Pawnee clay loam, 4 to 8 percent slopes, eroded	36.25	50.9%		IIIe		3883			39
7220	Burchard clay loam, 6 to 12 percent slopes	30.15	42.3%		IIIe	IVe	4193			53
7681	Wymore silty clay loam, 1 to 3 percent slopes	4.66	6.5%		Ile	Ile	3800			58
7050	Kennebec silt loam, occasionally flooded	0.20	0.3%		IIw		4361	114	38	82
Weighted Average					2.93	*-	4010.1	0.3	0.1	*n 46.3

*n: The aggregation method is "Weighted Average using all components"

*c: Using Capabilities Class Dominant Condition Aggregation Method

*- Irr Class weighted average cannot be calculated on the current soils data due to missing data.