

# Soils Map

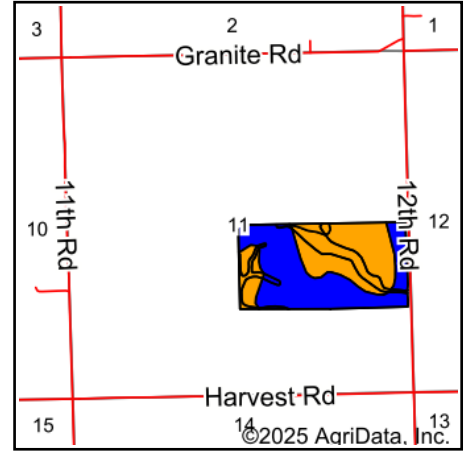

State: **Kansas**  
 County: **Marshall**  
 Location: **11-2S-7E**  
 Township: **Marysville**  
 Acres: **78.36**  
 Date: **1/16/2025**



Maps Provided By:



©2025 AgriData, Inc.

Soils data provided by USDA and NRCS.

Area Symbol: KS117, Soil Area Version: 25

Code	Soil Description	Acres	Percent of field	Non-Irr Class Legend	Non-Irr Class *c	Irr Class *c	Range Production (lbs/acre/yr)	*n NCCPI Soybeans
7681	Wymore silty clay loam, 1 to 3 percent slopes	40.91	52.2%		Ile	Ile	3800	58
7684	Wymore silty clay loam, 3 to 6 percent slopes, eroded	29.32	37.4%		IIIe	IVe	3832	50
7501	Pawnee clay loam, 4 to 8 percent slopes, eroded	8.13	10.4%		IIIe		3883	39
<b>Weighted Average</b>					<b>2.48</b>	<b>*-</b>	<b>3820.6</b>	<b>*n 53</b>

\*n: The aggregation method is "Weighted Average using all components"

\*c: Using Capabilities Class Dominant Condition Aggregation Method

\*- Irr Class weighted average cannot be calculated on the current soils data due to missing data.