

Wetlands Map

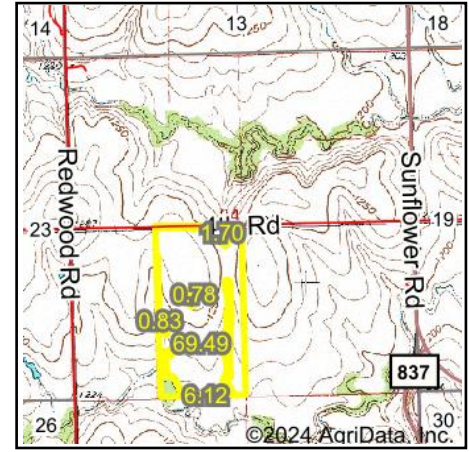

State: Kansas
Location: 24-10S-3E
County: Clay
Township: Republican
Date: 12/2/2024



Maps Provided By:



© AgriData, Inc. 2023 www.AgriDataInc.com

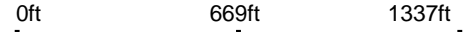

Classification Code	Type	Acres
	Total Acres	0.00

Data Source: National Wetlands Inventory website. U.S. DoI, Fish and Wildlife Service, Washington, D.C. <http://www.fws.gov/wetlands/>