

Application Due by Jan. 20

A. APPLICATION FOR LONG-TERM CONTRACTED ASSISTANCE THROUGH THE GRP PROGRAM

B. To be completed by NRCS; check appropriate box:

- This transaction is for CCC
 This transaction is for NRCS

C. State: Kansas D. County: Washington
1. Applicant Name and Address: Ivan R Berger, 2112 1st Road, Waterville, KS 66548
2. Applicant Name and Address: Delvin L. Berger, 3042 11th Road, Barnes, KS 66933
1 a. Phone: 785-562-6631 (cell #) 2 a. Phone: 785-763-4520

I (We) hereby apply for participation in this program and submit the following information in support of the application. I (We) hereby attest that the name(s) listed in Items 1 and 2, have complete control of the property described in Item 3 below.
3. Description and location of farm, ranch, or other unit: NE 4 32-4-6 (Marshall Co.)

4. The land is owned by the applicant(s): [X] Yes [] No If the answer to Item 4 is NO, provide an explanation below:

5. Description of area(s) needing treatment, Type and severity of problem(s), and treatment needed to correct the problem(s):

6. I (We) understand this application does not obligate the applicant(s) or _____ to enter into a contract.
6 a. Signature(s): Ivan R Berger 6 a. Date: 1-15-2010
6 b. Signature(s): Delvin L. Berger 6 b. Date: 1-15-2010

7. The land has been evaluated and determined to be eligible for the program for which applied ownership criteria is met by the following methods:
Personal Knowledge:
Knowledge of: [] 7 a. Conservation District Board Members [] 7 b. FSA Records [] 7 c. Deed [] 7 d. Other, explain:

8. If application is for WRP check appropriate box.
[] 8 a. 10 Year Restoration Agreement [] 8 b. 30 yr. easement [] 8 c. Permanent easement

9. If application is for GRP check appropriate box.
[] 9 a. 10 Year Contract [] 9 b. 15 Year Contract [] 9 c. 20 Year Contract [] 9 d. 30 Year Contract
[] 9 e. 30 Year Easement [X] 9 f. Permanent Easement

The signature by the NRCS representative signifies a CCC-NRCS transaction as indicated above.
10. Authorizing Official for: 10 a. Signature: 10 a. Date:

OMB DISCLOSURE STATEMENT

According to the Paperwork Reduction Act of 1995, an agency may not conduct or sponsor, and a person is not required to respond to a collection of information unless it displays a valid OMB control number. This valid OMB control number for this information collection is 0578-0013. The time required to complete this information collection is estimated to average .75 hours per response, including the time for reviewing instructions, searching existing data sources, gathering and maintaining the data needed, and completing and reviewing the collection information.

PRIVACY ACT STATEMENT

The above statements are made in accordance with the Privacy Act of 1974 (5 U.S.C. 552a). Furnishing this information is voluntary; however, failure to furnish correct, complete information will result in the withholding or withdrawal of such technical or financial assistance. The information may be furnished to other USDA agencies, the Internal Revenue Service, the Department of Justice, or other State or Federal law enforcement agencies, or in response to orders of a court, magistrate, or administrative tribunal.

NONDISCRIMINATION STATEMENT

The U.S. Department of Agriculture (USDA) prohibits discrimination in all its programs and activities on the basis of race, color, national origin, gender, religion, age, disability, political beliefs, sexual orientation, or marital or family status. (Not all prohibited bases apply to all programs.) Persons with disabilities who require alternative means for communication of program information (Braille, large print, audiotape, etc.) should contact USDA's TARGET Center at (202) 720-2600 (voice and TDD). To file a complaint of discrimination, write USDA Director, Office of Civil Rights, Room 326-W, Whitten Building, 1400 Independence Avenue, S.W., Washington, D.C. 20250-9410 or call (202) 720-9644.

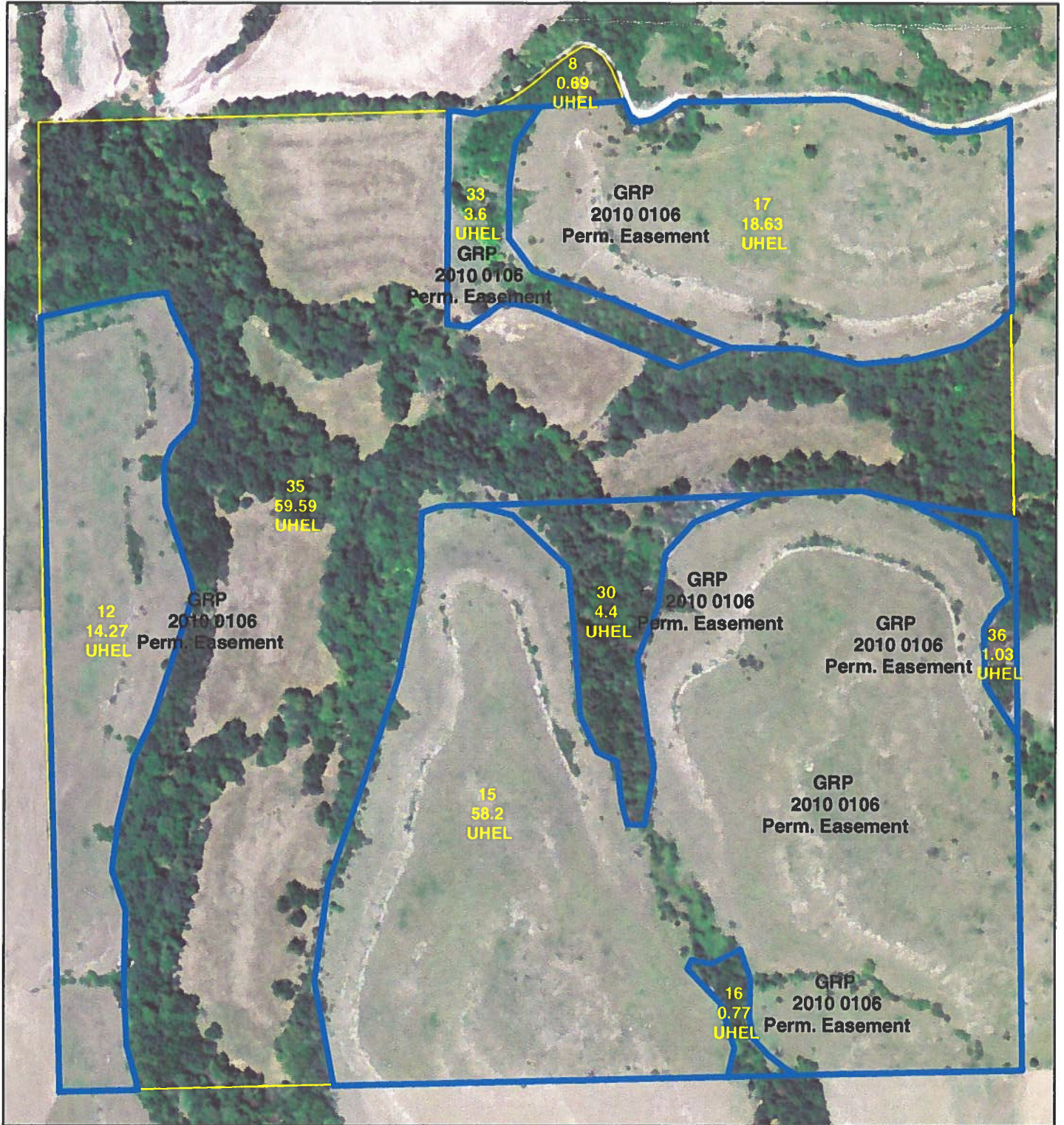

United States Department of Agriculture
Farm Service Agency

May 22, 2013

Farm: 2980
Tract: 2938

Washington County, KS

1:4,411



Disclaimer: Wetland identifiers do not represent the size, shape or specific determination of the area. Refer to your original determination (CPA-026 and attached maps) for exact wetland boundaries and determinations, or contact NRCS.