

Wetlands Map

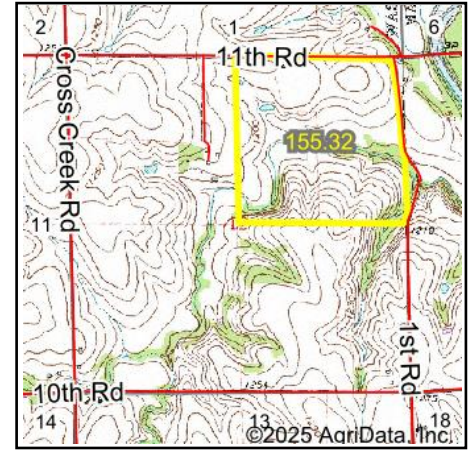

State: **Kansas**
 Location: **12-4S-5E**
 County: **Washington**
 Township: **Barnes**
 Date: **2/12/2025**



Maps Provided By:



© AgriData, Inc. 2023 www.AgriDataInc.com

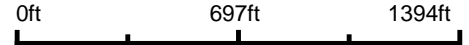

Classification Code	Type	Acres
R4SBC	Riverine	2.16
PABFh	Freshwater Pond	0.56
Total Acres		2.72

Data Source: National Wetlands Inventory website. U.S. Dol, Fish and Wildlife Service, Washington, D.C. <http://www.fws.gov/wetlands/>